

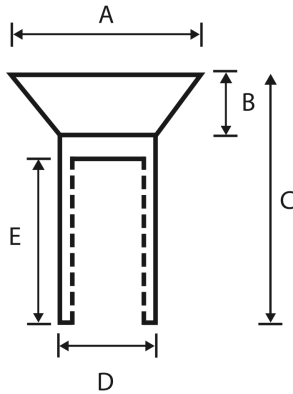

FICHA TÉCNICA

TUERCA BARRIL AVELLANADA - ACERO INOXIDABLE A2



DIMENSIONES (mm)

MEDIDAS	M4	M5	M6	M8	M10
DIMENSIONES	12 mm	16 mm	16 mm	20 mm	25 mm
A	8.0	10.0	12.0	16.0	20.0
B	2.1	2.6	3.0	4.0	4.75
C	12.0	16.0	16.0	20.0	25.0
D	5.3	6.35	8.0	10.0	12.5
E	6.0	6.0	7.0	10.0	14.0
LONGITUD	12mm	16mm	20mm	25mm	DRIVER SIZE
GROSOR					
M4	RTCBN 0412				T20
M5		RTCBN 0516			T25
M6		RTCBN 0616			T30
M8			RTCBN 0820		T40
M10				RTCBN 1025	T45

MATERIAL Y ACABADO

Material: Acero inoxidable A2

Tratamiento de calor: Ninguno

Acabado: Color natural